

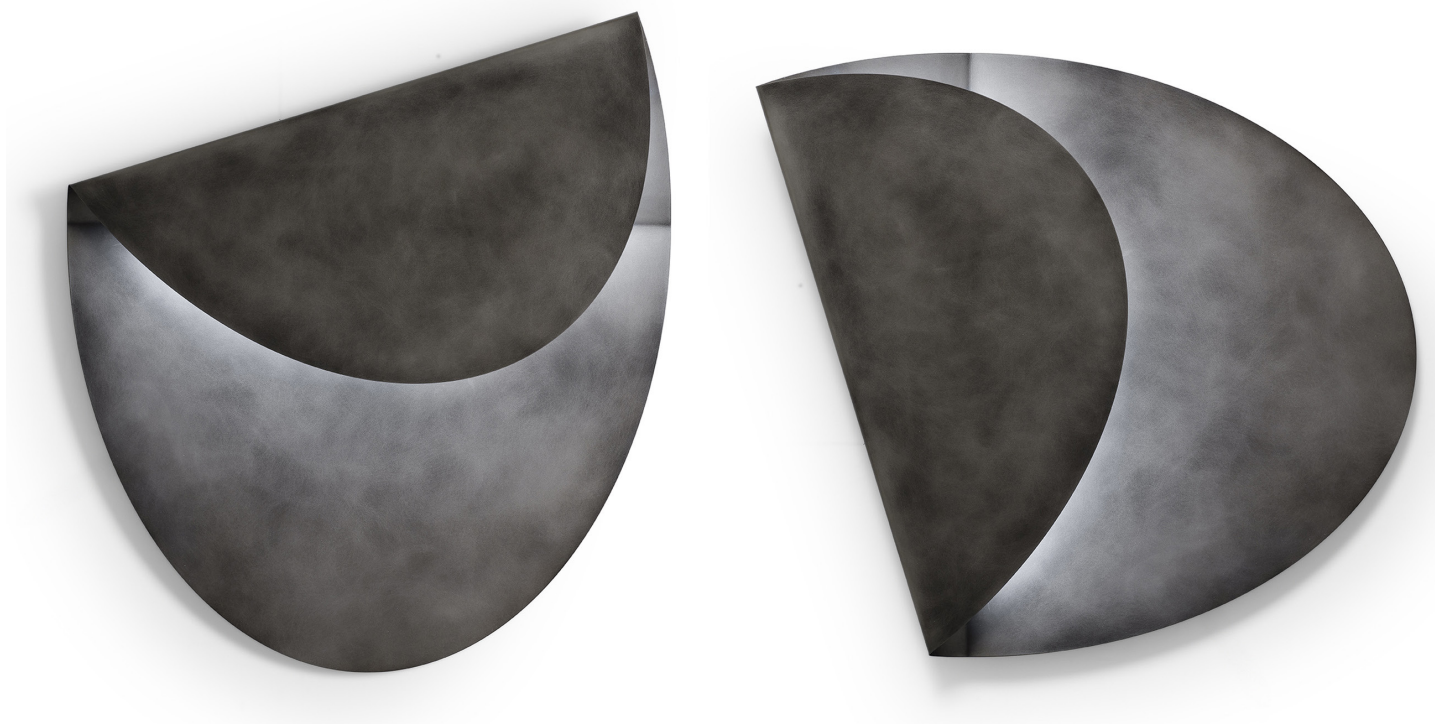

# Istruzioni di Montaggio

## *Assembly Instructions*



## PLIER

## Lampada | *Lamp*

Designer: Alessandro Pasinelli  
Anno | Year: 2025  
Materiali | *Materials*: Lampada da parete con struttura in metallo | *Wall lamp with metal frame*

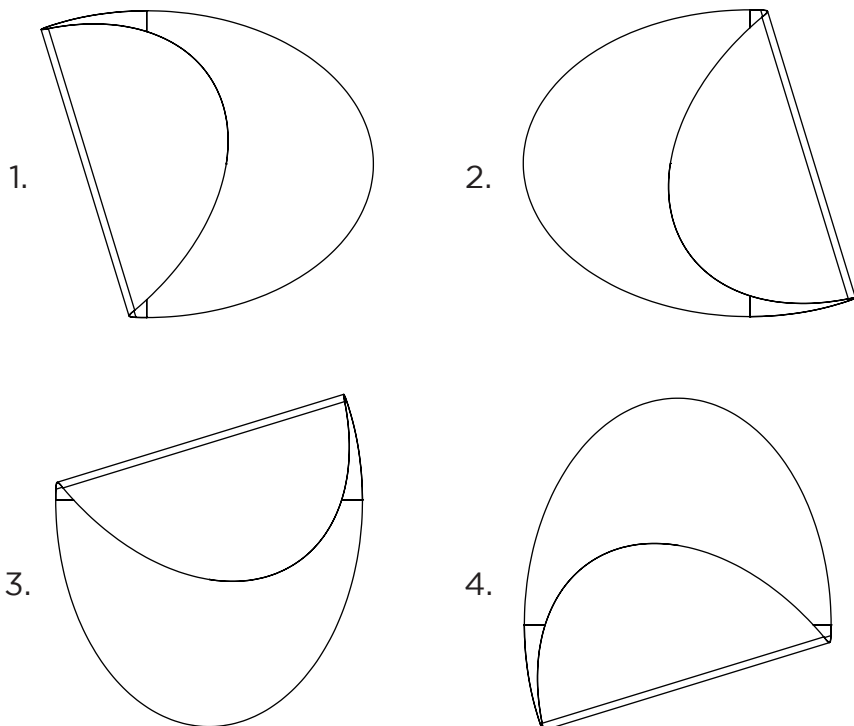
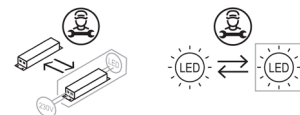

**1.** Scegliere la posizione della lampada, successivamente forare il muro seguendo le misure indicate nei disegni.

**1.** Choose the direction of the lamp and where to position it, then drill holes in the wall following the measurements indicated in the drawings.

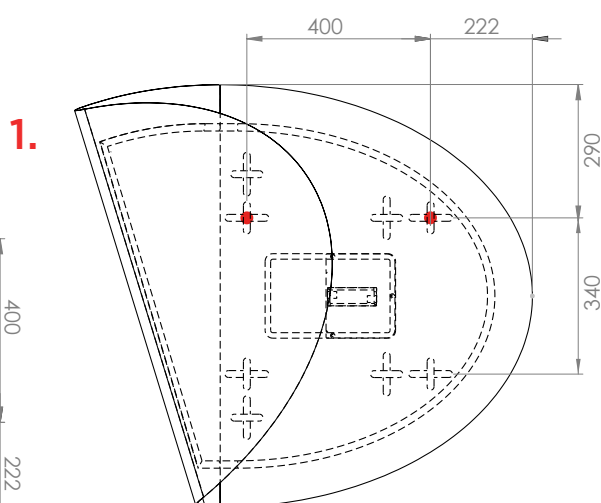
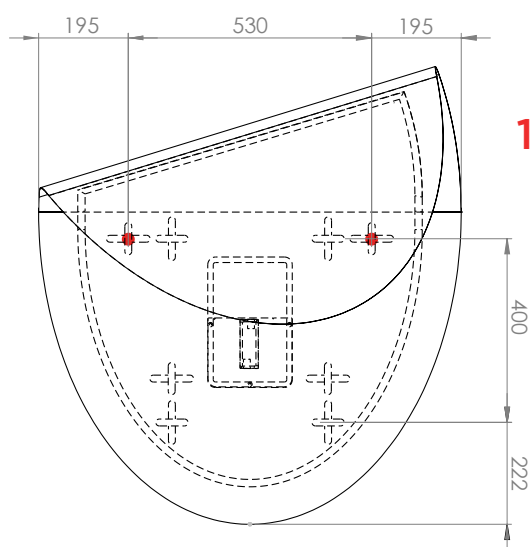

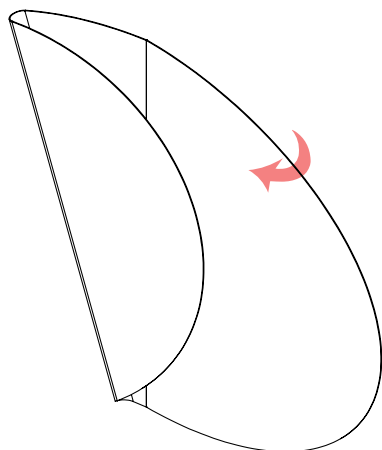

**2.** Svitare il carter posteriore per estrarre il cablaggio

**2.** *Unscrew the rear casing allowing the wiring harness to be pulled out*

**3.** Collegare il cablaggio della lampada con quello domestico a parete e rimontare il carter di protezione.

**3.** *Connect the wiring of the lamp with the domestic wiring on the wall.*

**4.** Appendere la lampada ai supporti sul muro precedentemente installati.

**4.** *Hang the lamp on the wall brackets previously installed.*

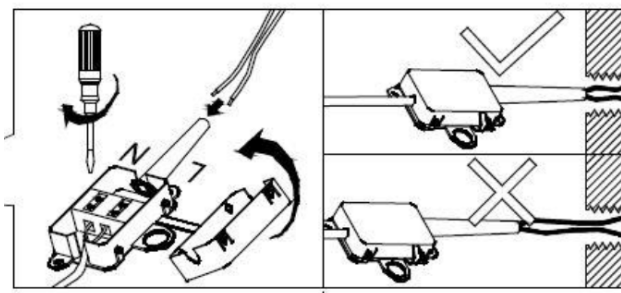
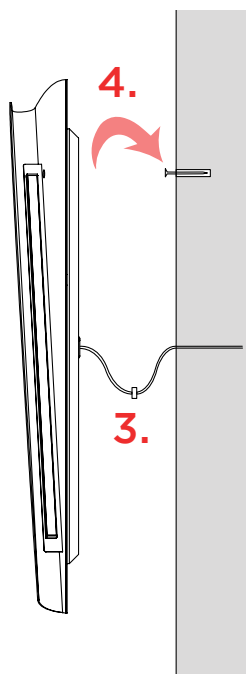
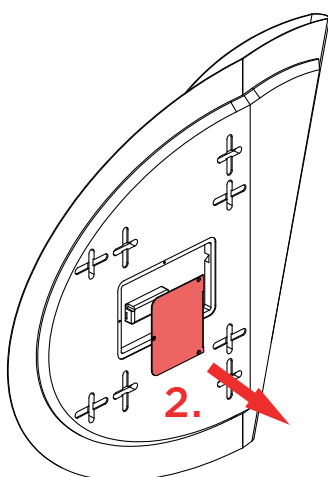

**N.B. ganci per montaggio a parete non forniti.**  
*Hang the lamp on the wall brackets previously installed.*

**AVVERTENZA: Tutte le operazioni e la sostituzione del cavo di alimentazione dovranno essere eseguite da personale qualificato**  
**WARNING: All operations and the replacement of the power cable must be performed by qualified personnel**

### Istruzioni per la pulizia:

Utilizzare un panno asciutto

### Cleaning instructions:

Use a damp cloth



## PLIER

## Lampada | *Lamp*

Designer: Alessandro Pasinelli  
Anno | Year: 2025  
Materiali | *Materials*: Lampada da parete con struttura in metallo | *Wall lamp with metal frame*

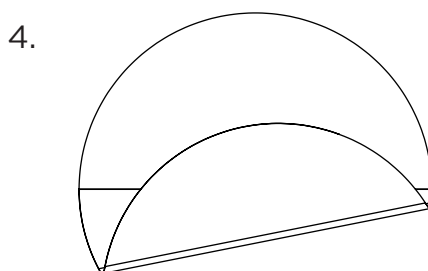
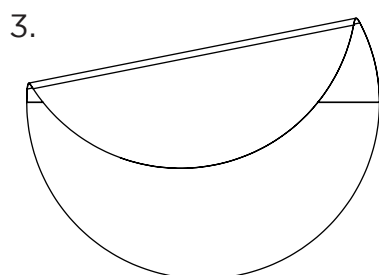
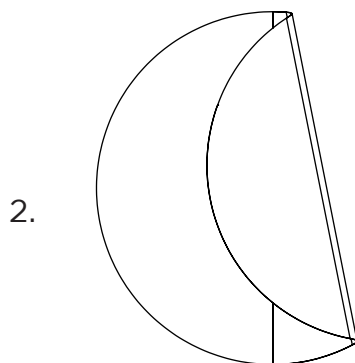
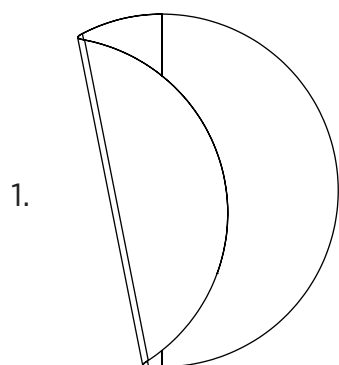
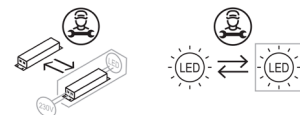

**1.** Scegliere la posizione della lampada, successivamente forare il muro seguendo le misure indicate nei disegni.

**1.** Choose the direction of the lamp and where to position it, then drill holes in the wall following the measurements indicated in the drawings.

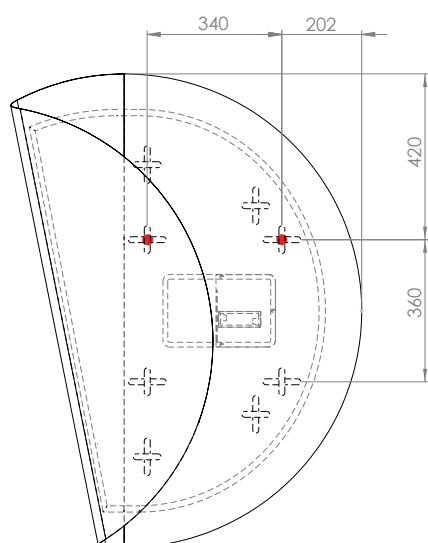

**1.**

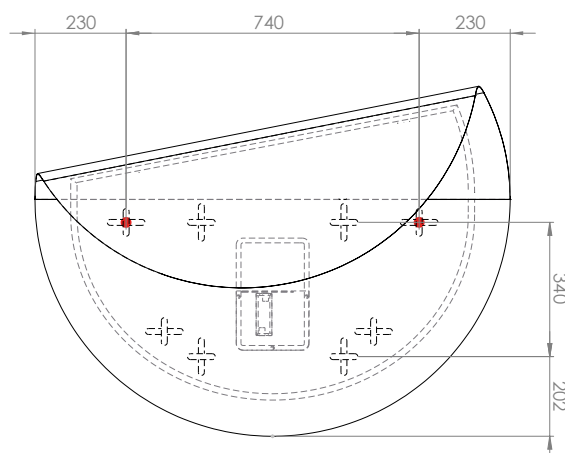

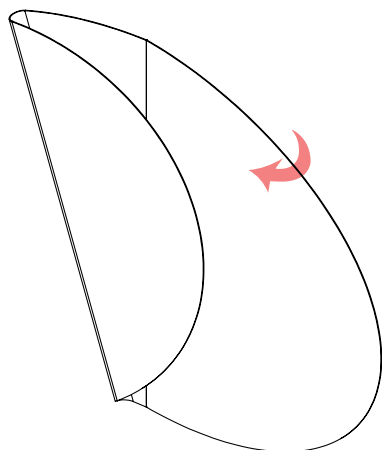

**2.** Svitare il carter posteriore per estrarre il cablaggio

**2.** *Unscrew the rear casing allowing the wiring harness to be pulled out*

**3.** Collegare il cablaggio della lampada con quello domestico a parete e rimontare il carter di protezione.

**3.** *Connect the wiring of the lamp with the domestic wiring on the wall.*

**4.** Appendere la lampada ai supporti sul muro precedentemente installati.

**4.** *Hang the lamp on the wall brackets previously installed.*

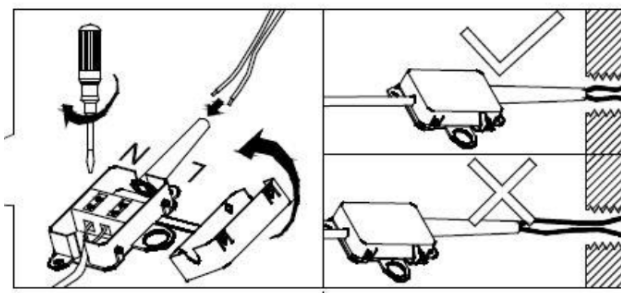
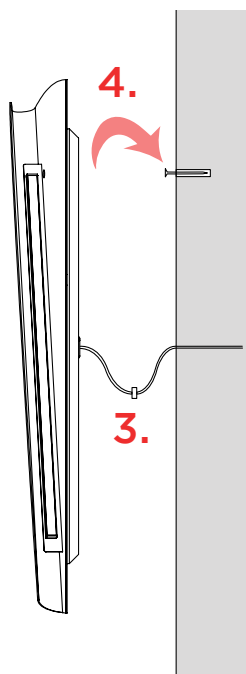
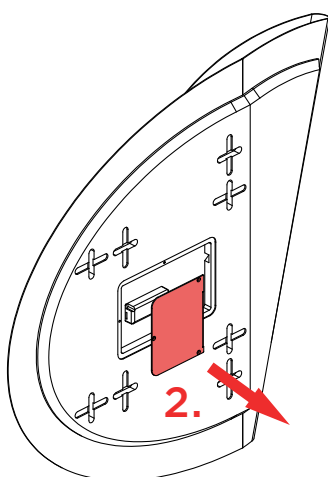

**N.B. ganci per montaggio a parete non forniti.**  
*Hang the lamp on the wall brackets previously installed.*

**AVVERTENZA: Tutte le operazioni e la sostituzione del cavo di alimentazione dovranno essere eseguite da personale qualificato**  
**WARNING: All operations and the replacement of the power cable must be performed by qualified personnel**

### Istruzioni per la pulizia:

Utilizzare un panno asciutto

### Cleaning instructions:

Use a damp cloth